



- Stainless Steel Frame
- Flat Contact Bows
- Double Sided Keyways
- Smooth Ratchet

Sentry handcuffs are stainless steel restraints with I-Beam inspired frames. They incorporate the innovative advances in handcuff design that were pioneered by ASP. Robust and rigid, they have smooth, round edges with conical bows. This revolutionary new design has a frame that is cut from ordnance grade stainless steel and permanently joined by heat treated spiral pins. The result is a handcuff that provides a significant advance in restraint technology.

Sentry Handcuffs were designed in the field. Input came from officers and instructors in the over 100 nations where ASP conducts training. As a result, this ASP design incorporates the practical features most requested by officers on the street.

Flat contact bows improve application. These forged steel contacts are highly radiused to prevent injury. There is a keyway and double lock slot on each side of each restraint. Both double and single locks are released by turning the key in a single direction. The frame geometry, deep set teeth and precision smooth action eliminate the need for back loading.

Sentry Cuffs employ innovative technologies that are available only from ASP. These are duty restraints with exclusive features that increase both performance and safety.

Sentry Cuffs . . . Value Through Superior Design

Hinge

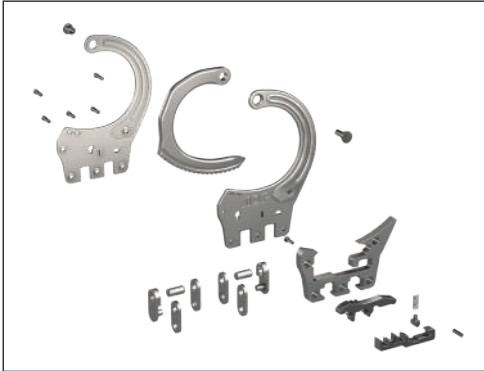

Chain

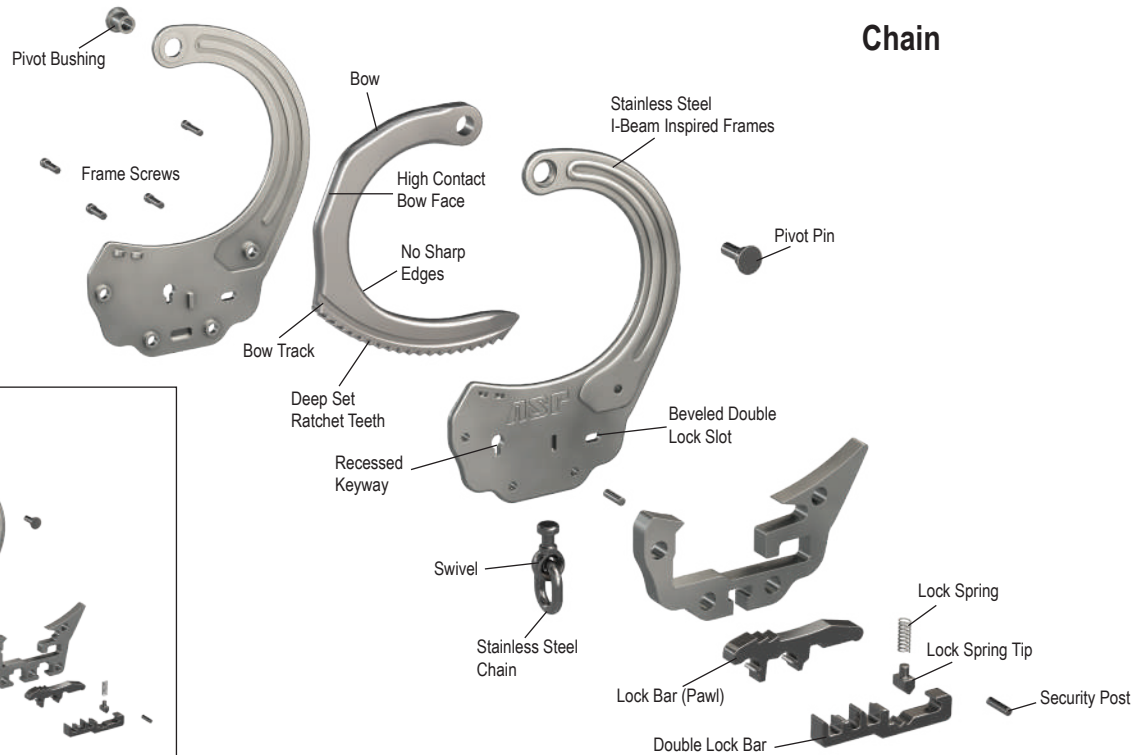

Background

High contact face
No sharp edges
Two-sided double locks
Two-sided keyways
One direction key turn releases main and double lock

Specifications

	Chain	
Length	9.4"	239 mm
Width	3.125"	79 mm
Weight	12.4 ounces	352 grams
Construction	Stainless steel	
Edge Radius	.035" minimum (1mm)	

	Hinge	
Length	9.1"	231 mm
Width	3.125"	79 mm
Weight	13.9 ounces	394 grams
Construction	Stainless steel	
Edge Radius	.035" minimum (1mm)	

Frame

Computer designed
Precision cut
I-Beam reinforced

Chain Link

Stainless steel chain
Free rotating swivel

Hinge Link

Stainless steel
Four point rotation

Lock Set

Dual keyways
Stainless security posts
Dual double lock slots
Dual release lock bar (pawl)

Bow

Conical geometry
Integral frame track
Deep set teeth
High contact face
Serial numbered pin
Stainless pivot pin

Warranty

Limited Lifetime



The optional **Sentry Exo Case** is specifically designed for ASP Sentry Handcuffs.



ASP handcuff keys are back set, precision machined and heat treated.



securityprousa

Phone: 800.264.8273

Address: 8543 Venice Blvd, Los Angeles, CA